

HEPA FILTER BOX – CKF-01 /CKF-01A

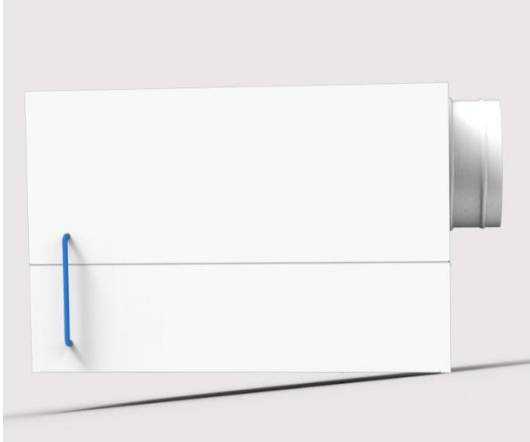

CKF-01

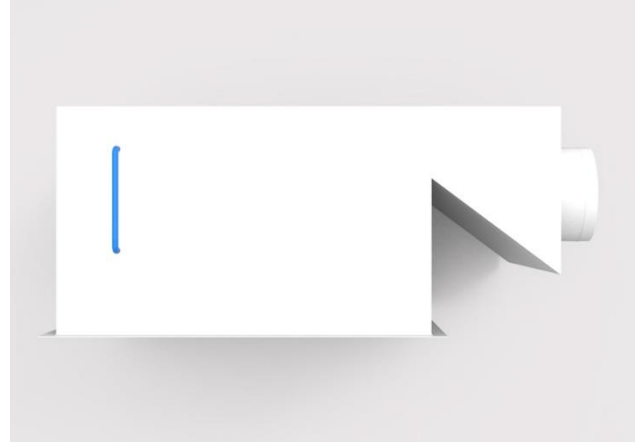

CKF-01A

AREAS OF USAGE AND FEATURES: CKF-01/01A Hepa filter boxes are used together with hepa filter and diffuser in places where hygiene is required. Hepa filter is manufactured in a structure with full leak proof feature. Since the filter and diffuser must be removed frequently, they are easy to install. Hepa filter boxes are manufactured in two ways as side or top, considering the conditions in the worksite environment. Additional blind case is used in clip-in ceiling applications.

MATERIAL: It is manufactured as welded from 1,2 mm dkp plate as standard. Box surfaces are covered with electro static paint. Optionally, it can be manufactured from 1.2 mm stainless plate.

INSTALLATION: Diffuser assembly is bolted from the hub as standard.

COATING: Electrostatic painted or 304 stainless

ACCESSORIES: Regulatory damper, Hepa filter, Diffuser



TECHNICAL MEASUREMENT

CKF-01 - HEPA FILTER BOX WITH SIDE ENTRY:

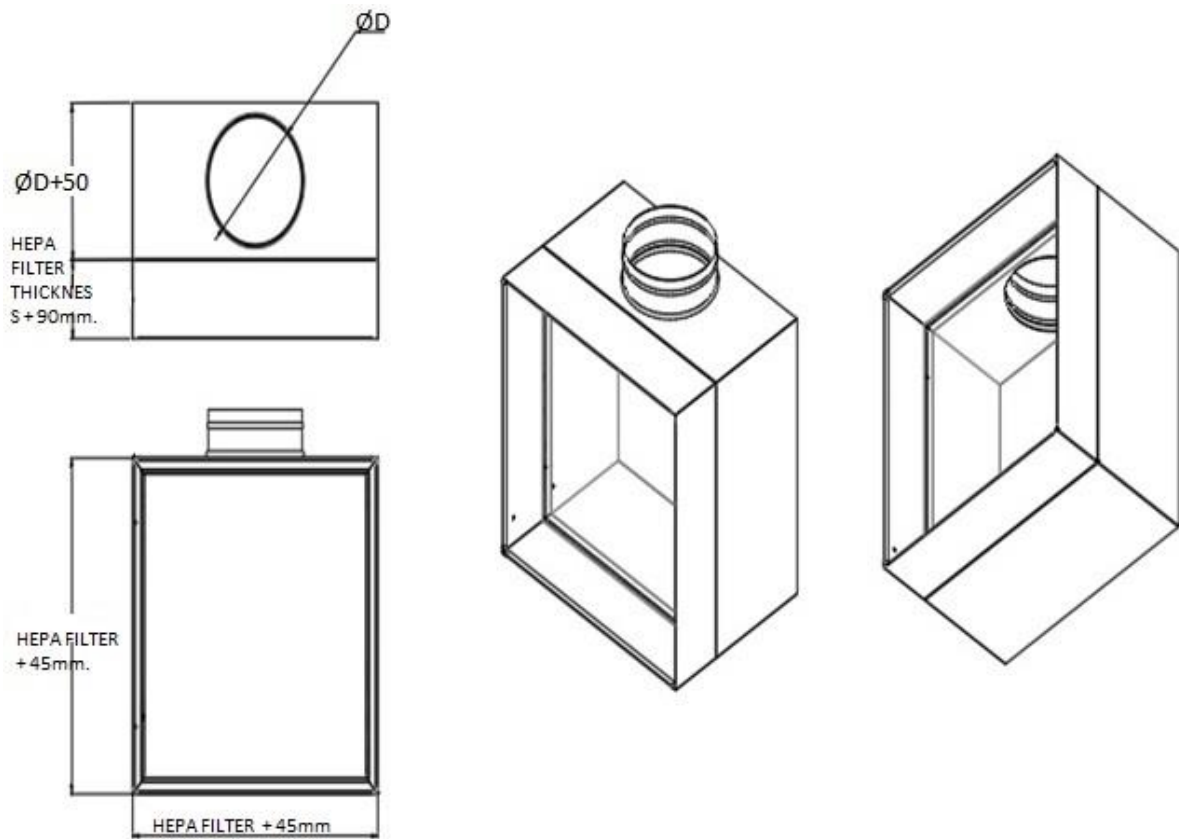

CKF-01A - SIDE INLET HEPA FILTER BOX:

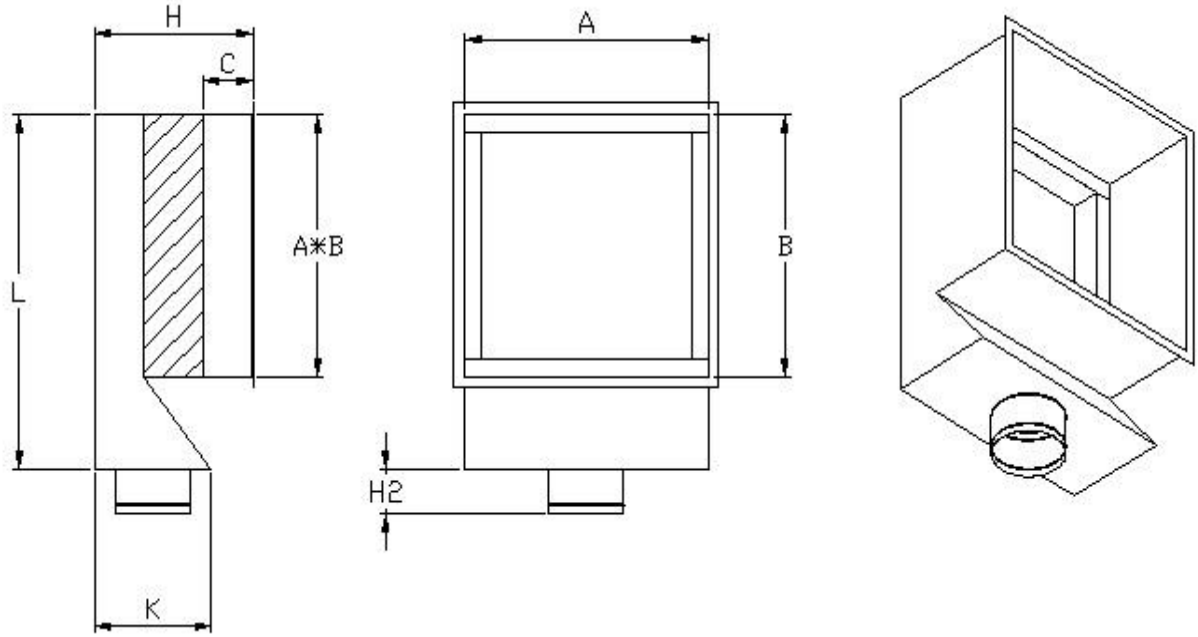

HEPA FILTER BOX SIDE ENTRY (H13 HEPA FILTER)										
HEPA FILTER DIMENSIONS	SURFACE AREA (m ²)	AIR FLOW (m ³ / h)	PRESSURE LOSS (Pa)	A	B	C	Ø D	H	K	H2
305*305*78	2,5	150	110	345	345	100	145	291	195	100
457*457*78	5,6	335	110	497	497	100	195	316	245	100
535*535*78	9,1	460	110	575	575	100	195	316	245	100
575*575*78	9,7	535	110	615	615	100	195	316	245	100
305*610*78	5,1	300	110	345	650	100	195	316	245	100
457*610*78	7,2	450	110	497	650	100	195	316	245	100
610*610*78	10,2	610	110	650	650	100	195	316	245	100
610*762*78	12,5	750	110	650	800	100	195	316	245	100
610*915*78	15,1	900	110	650	955	100	250	343	300	100
610*1220*78	20,6	1200	110	650	1260	100	315	376	365	100
305*305*149	3,8	250	250	345	345	100	145	362	195	100
457*457*149	8,5	560	250	497	497	100	195	387	245	100
535*535*149	12,9	770	250	575	575	100	195	387	245	100
575*575*149	13,8	900	250	615	615	100	195	387	245	100
305*610*149	7,5	500	250	345	650	100	195	387	245	100
457*610*149	9,9	750	250	497	650	100	195	387	245	100
610*610*149	14,9	1000	250	650	650	100	195	387	245	100
610*762*149	18,6	1250	250	650	800	100	195	387	245	100
610*915*149	22,4	1560	250	650	955	100	250	414	300	100
610*1220*149	29,8	2000	250	650	1260	100	315	447	365	100

TOP ENTRY HEPA FILTER BOX:

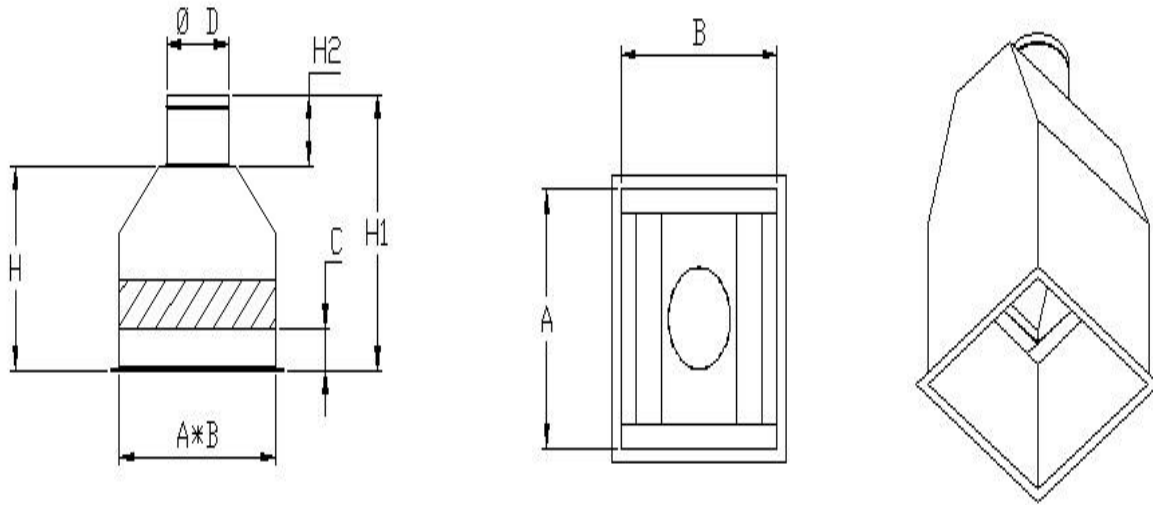

HEPA FILTER BOX SIDE ENTRY (H13 HEPA FILTER)										
HEPA FILTER DIMENSIONS	SURFACE AREA (m ²)	AIR FLOW (m ³ / h)	PRESSURE LOSS (Pa)	A	B	C	Ø D	H	H1	H2
305*305*78	2,5	150	110	345	345	100	145	240	340	100
457*457*78	5,6	335	110	497	497	100	195	240	340	100
535*535*78	9,1	460	110	575	575	100	195	240	340	100
575*575*78	9,7	535	110	615	615	100	195	240	340	100
305*610*78	5,1	300	110	345	650	100	195	240	340	100
457*610*78	7,2	450	110	497	650	100	195	240	340	100
610*610*78	10,2	610	110	650	650	100	195	240	340	100
610*762*78	12,5	750	110	650	800	100	195	240	340	100
610*915*78	15,1	900	110	650	955	100	250	240	340	100
610*1220*78	20,6	1200	110	650	1260	100	315	240	340	100
305*305*149	3,8	250	250	345	345	100	145	311	411	100
457*457*149	8,5	560	250	497	497	100	195	311	411	100
535*535*149	12,9	770	250	575	575	100	195	311	411	100
575*575*149	13,8	900	250	615	615	100	195	311	411	100
305*610*149	7,5	500	250	345	650	100	195	311	411	100
457*610*149	9,9	750	250	497	650	100	195	311	411	100
610*610*149	14,9	1000	250	650	650	100	195	311	411	100
610*762*149	18,6	1250	250	650	800	100	195	311	411	100
610*915*149	22,4	1560	250	650	955	100	250	311	411	100
610*1220*149	29,8	2000	250	650	1260	100	315	311	411	100